

Propeller Assembly

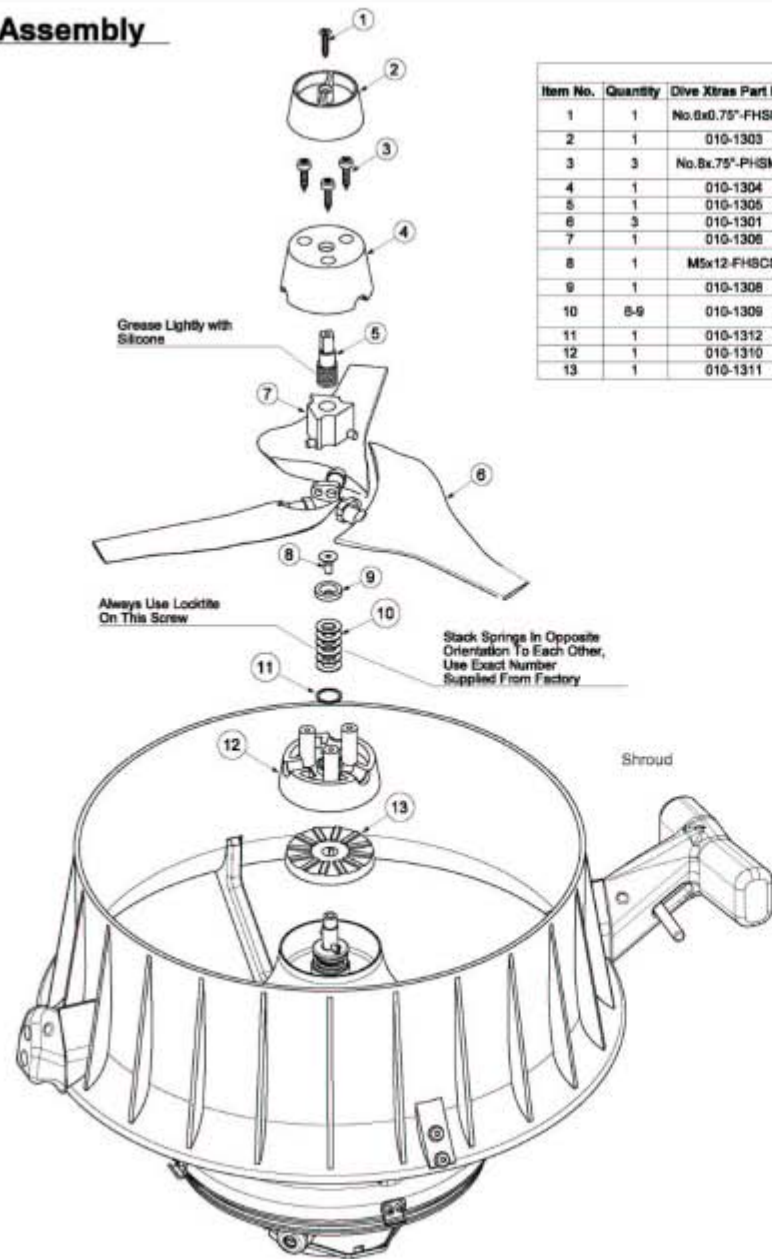

Propeller Assembly

| Rev. | Description | Date |
|------|-------------|--------|
| 1 | New Release | 3/9/05 |



| Propeller Assembly | | | | |
|--------------------|----------|---------------------|------------------|--|
| Item No. | Quantity | Dive Xtras Part No. | Oceanic Part No. | Description |
| 1 | 1 | No. 6x.75"-FHMS | MAKO-712863 | No. 6 x 0.75" Flat Head Phillips Sheet Metal Screw 316 SS |
| 2 | 1 | 010-1303 | MAKO-712857-01 | Knob, Variable Pitch. |
| 3 | 3 | No. 8x.75"-PHMS | MAKO-712932 | No. 8 x 0.75" Pan Head Phillips Sheet Metal Screw 316 SS |
| 4 | 1 | 010-1304 | MAKO-712860 | Hub, Outer, Mako. |
| 5 | 1 | 010-1305 | MAKO-712861 | Shaft, Yoke, Mako. |
| 6 | 3 | 010-1301 | MAKO-712759 | Blade, Propeller, Mako. |
| 7 | 1 | 010-1308 | MAKO-712862 | Yoke, Prop Blade, Mako. |
| 8 | 1 | M5x12-FHSC6 | MAKO-712866 | M5 x 12 Metric Flat Head Socket Cap Screw 316 Stainless steel |
| 9 | 1 | 010-1308 | MAKO-712864 | Washer, Clutch, Mako |
| 10 | 8-9 | 010-1309 | MAKO-712865 | WASHER, CLUTCH SPRING, MAKO (Also www.mcmaster.com PN 9713K06) |
| 11 | 1 | 010-1312 | MAKO-712901 | Ring, Clutch, Mako. |
| 12 | 1 | 010-1310 | MAKO-712866 | Hub, Inner, Mako. |
| 13 | 1 | 010-1311 | MAKO-712867 | Plate, Clutch, Mako. |

| Rear Seal Assembly | | | | |
|--------------------|----------|---------------------|------------------|--------------------------------------|
| Item No. | Quantity | Dive Xtras Part No. | Oceanic Part No. | Description |
| 1 | 1 | 010-1315 | | Dowel pin, 0.125" Dia, 1" Long, SS |
| 2 | 1 | 010-1314 | | Retaining Ring, 0.375" Dia Shaft, SS |
| 3 | 1 | 010-1008 | | Seal, Shaft. |

Rear Shaft Seal Detail

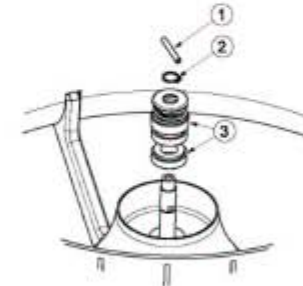

Parts

dive X

© 2004 DIVE XTRAS. ALL RIGHTS RESERVED. THIS DOCUMENT IS UNCLASSIFIED UNLESS INDICATED BY THE DOCUMENT OR THE PROPERTY OF ANY PART OF IT. AS OF THE 17th APRIL 2004. PLEASE DO NOT REPRODUCE THIS DOCUMENT UNLESS YOU HAVE BEEN AUTHORIZED TO DO SO.

All dimensions are in mm. Detail & finish all sharp edges.

Engineer: **Ben McGeever**

Propeller Assembly Exploded View

Drawing No: XXX Rev: 1 Sheet: 1

Stage 1

Scooter ready to take new propeller assembly.

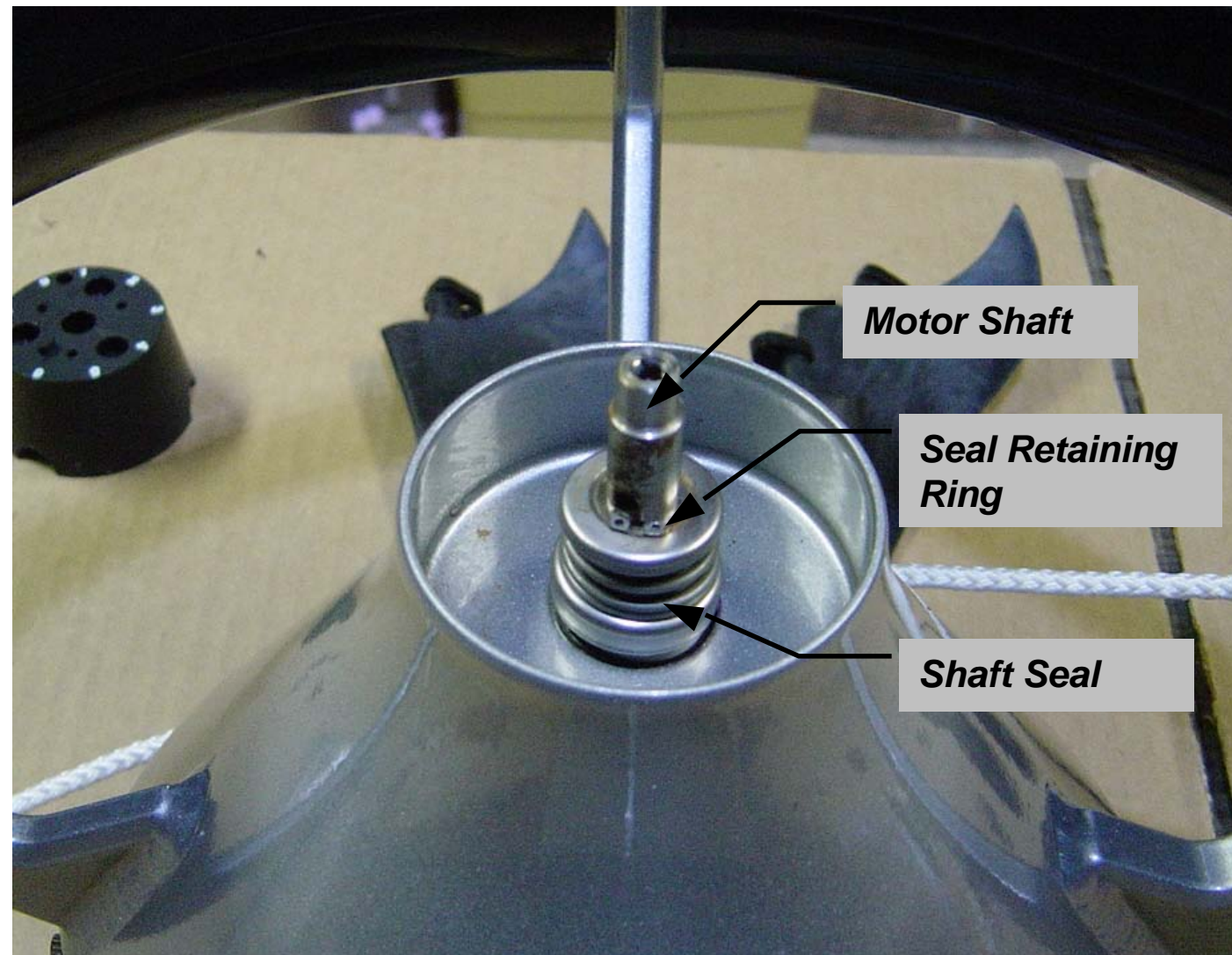

Stage 2

Fit Dowel Pin. The dowel pin transmits the torque from the motor to the prop.

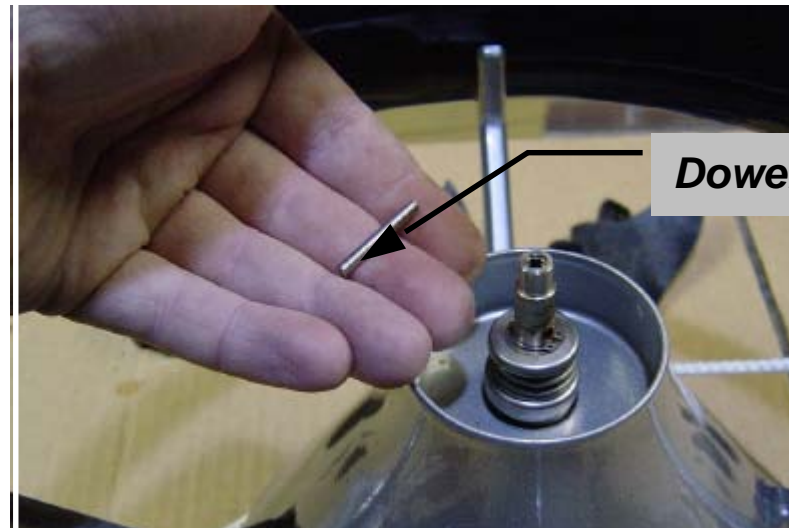

Dowel Pin

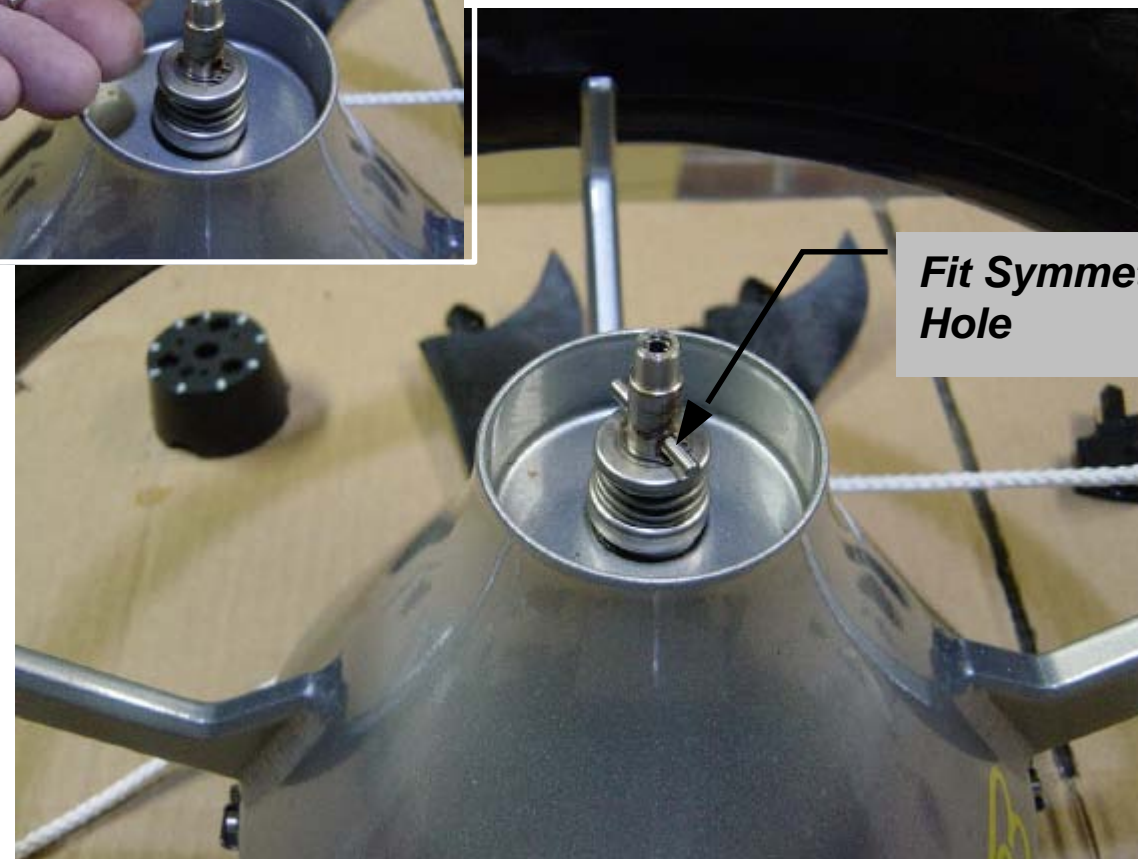

Fit Symmetrically in Hole

Stage 3

Fit Clutch Plate. Make sure the slot in the base engages with the pin.

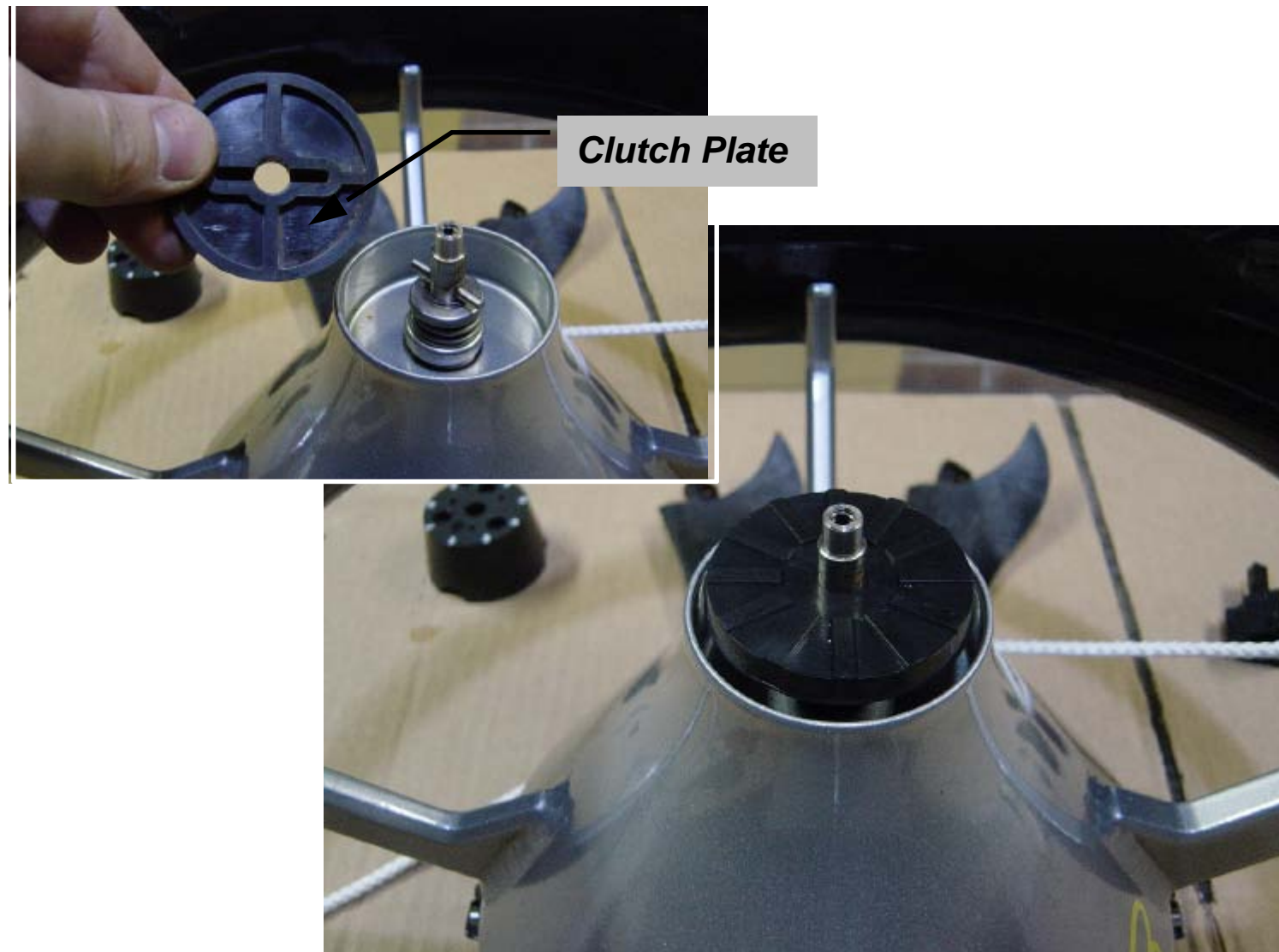

Stage 4

Fit Inner Hub. Make sure the clutch serrations engage correctly and the bottom doesn't rub on the scooter body.

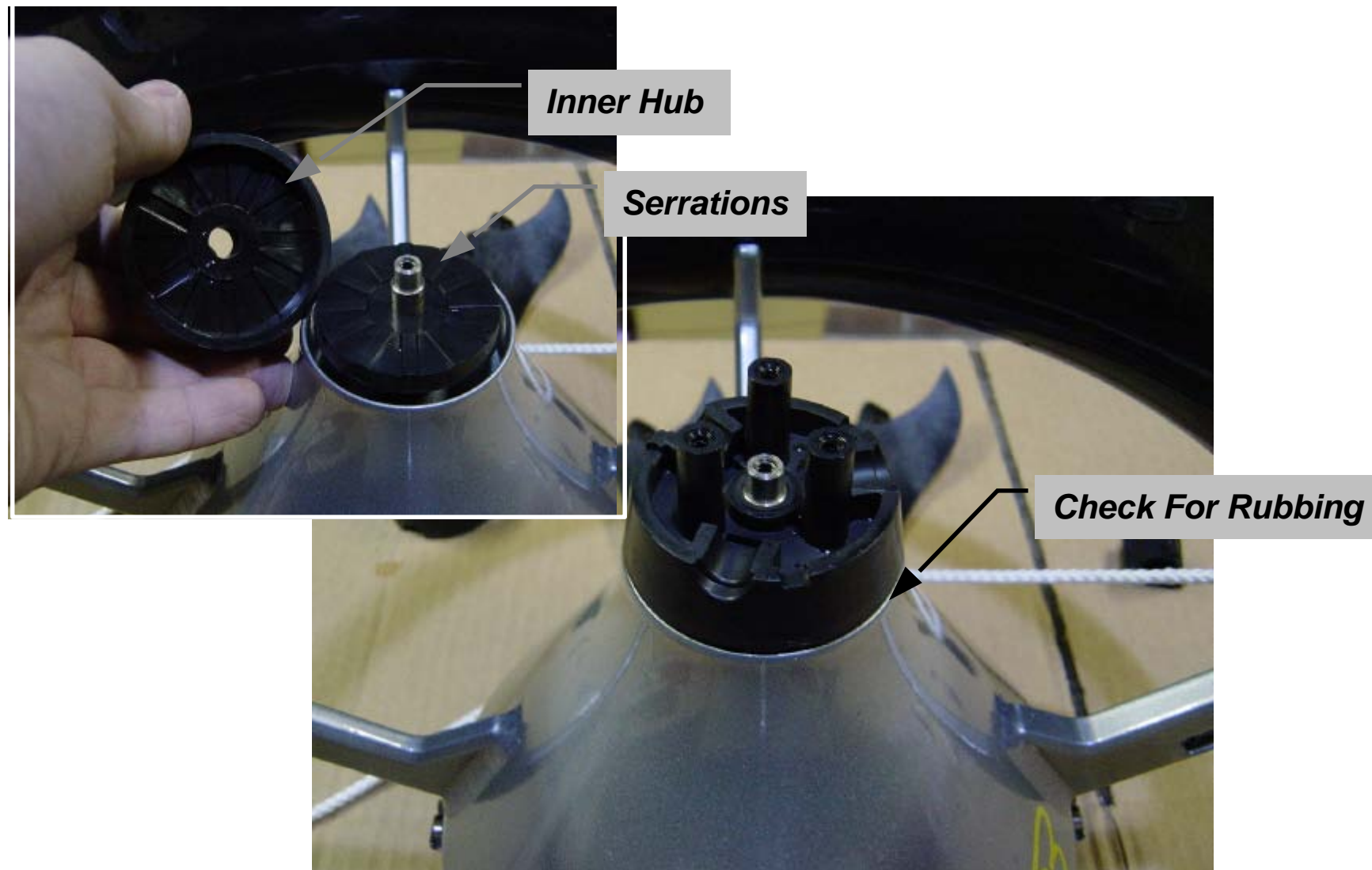

Stage 5

Fit Ring, Clutch. This prevents the springs digging into the plastic

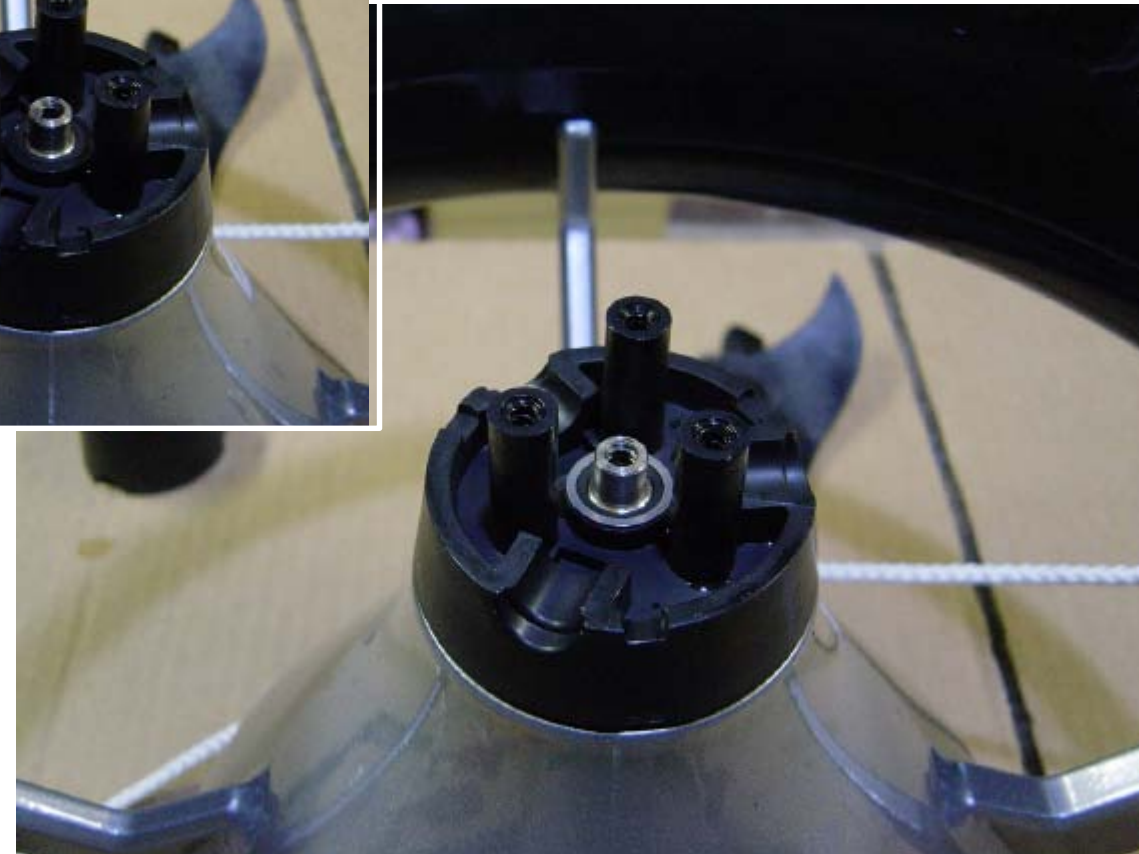
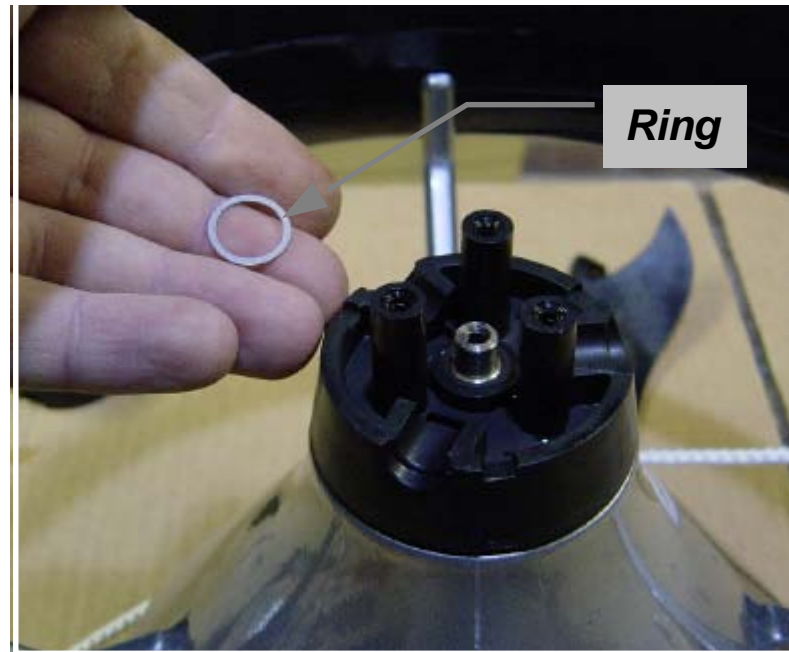

Stage 6

Fit Clutch Springs. 9 springs are normally fitted. They have a slight cup and are fitted back to back. They can be assembled prior to fitting on a screwdriver

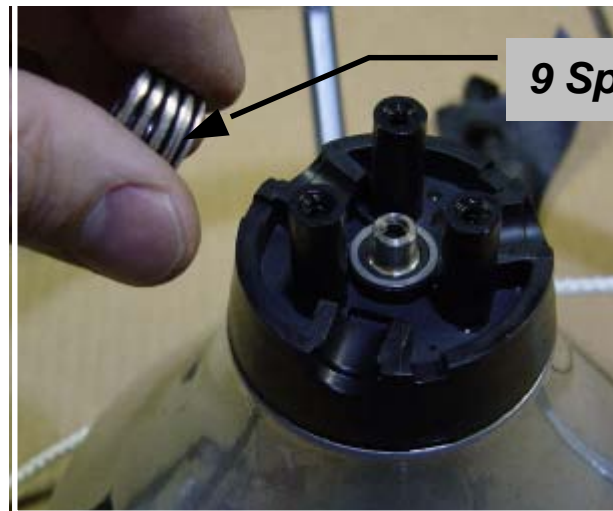

9 Springs

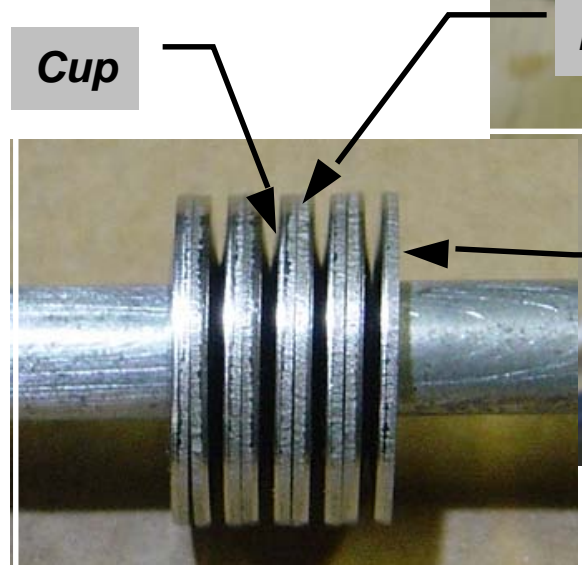

Cup

Back To Back

This End Down

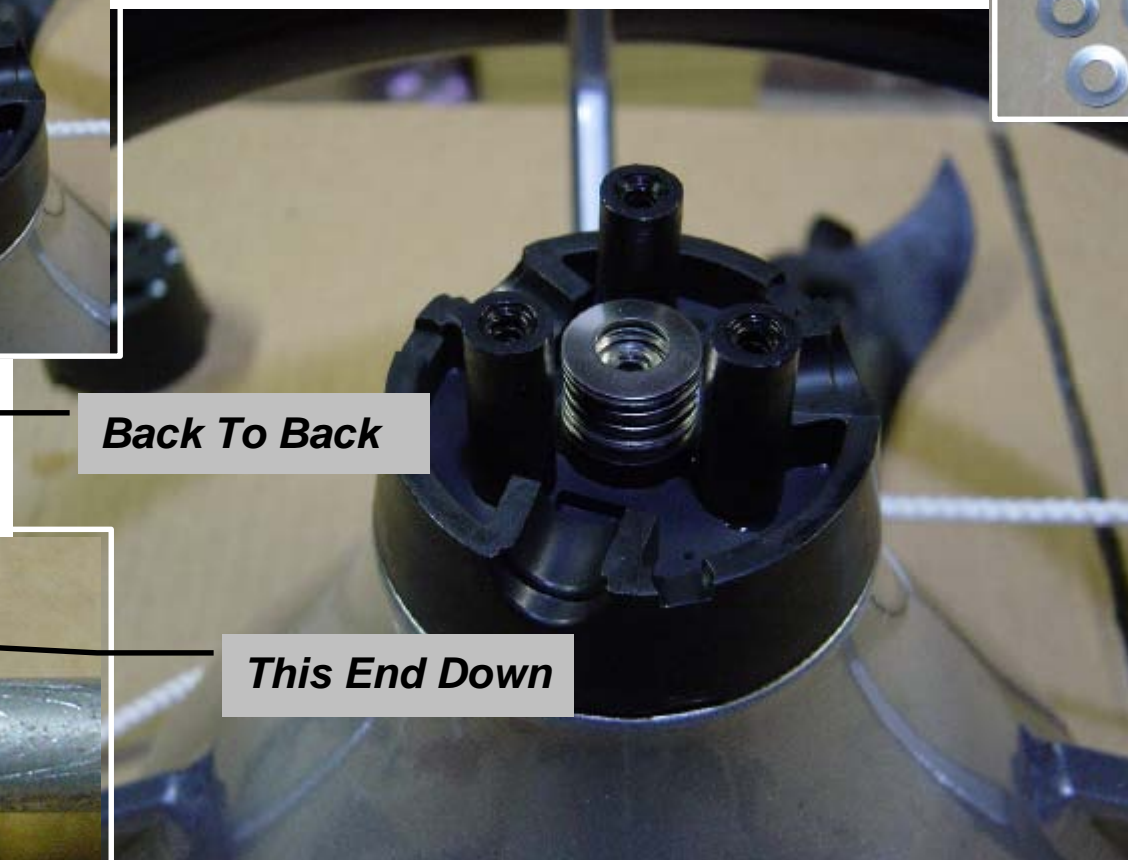

Stage 7

Fit Washer, Clutch.



Stage 8

Fit Cap Screw. Make sure to use medium strength locktite and to keep all the springs in alignment. Spring stack when compressed should be almost solid, but not quite. If gaps are large add extra springs

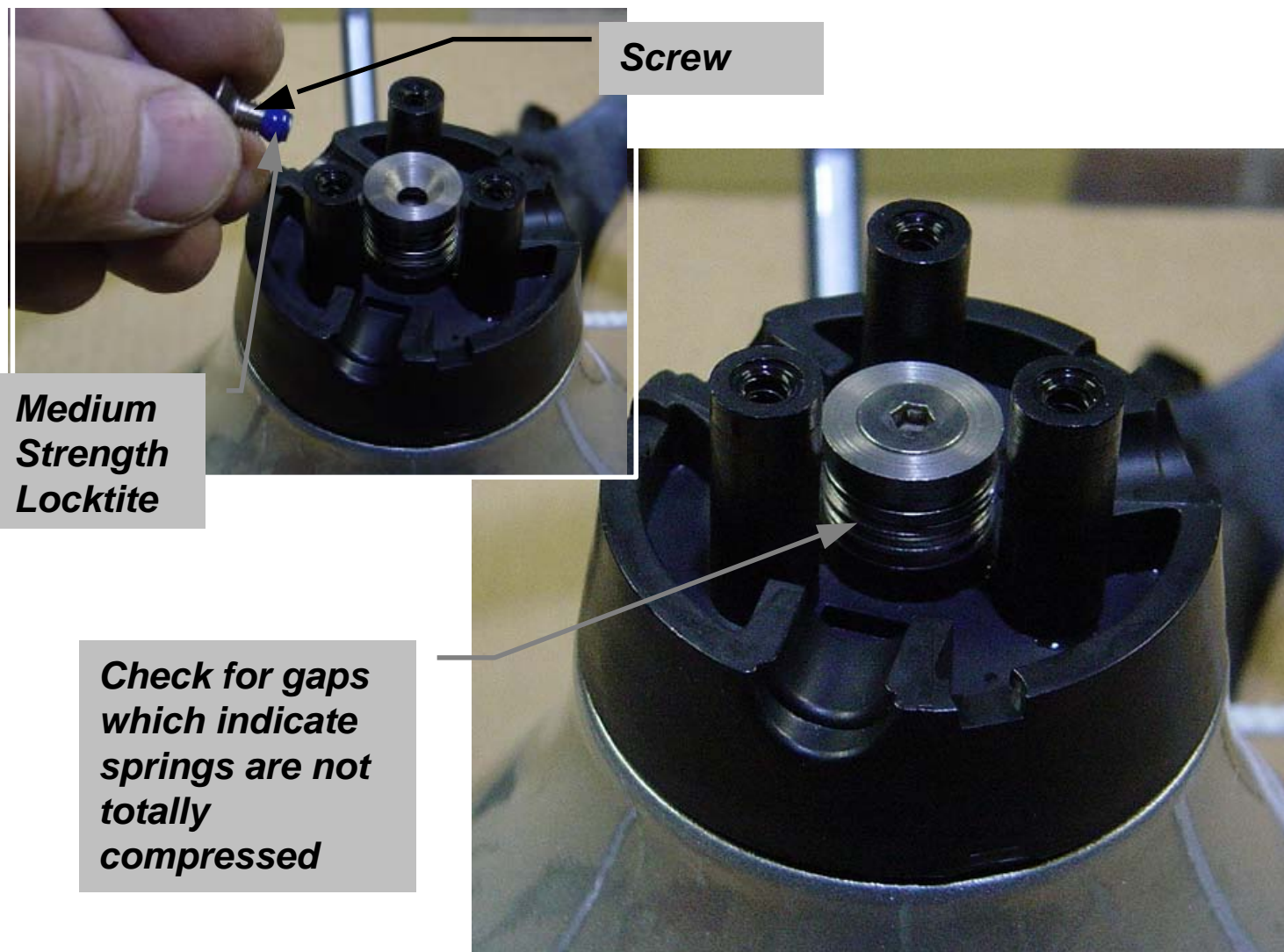

Screw

**Medium
Strength
Locktite**

**Check for gaps
which indicate
springs are not
totally
compressed**

Stage 9

Fit Yoke and Shaft. Screw together prior to assembly

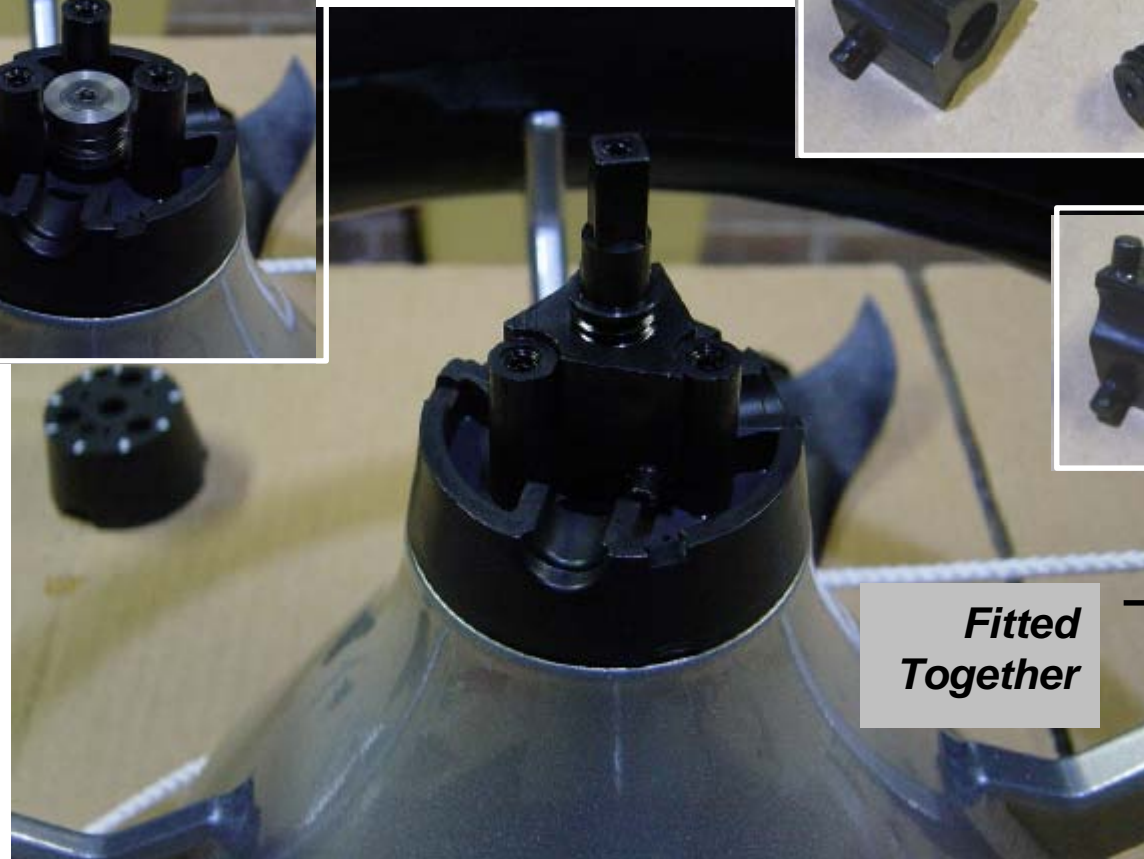
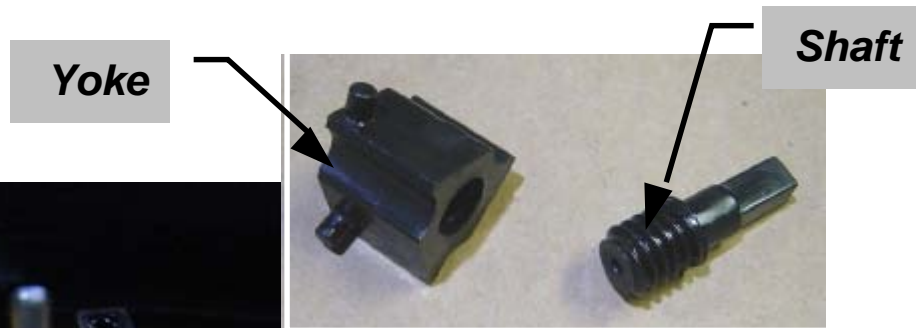

Stage 10

Fit Propeller Blades

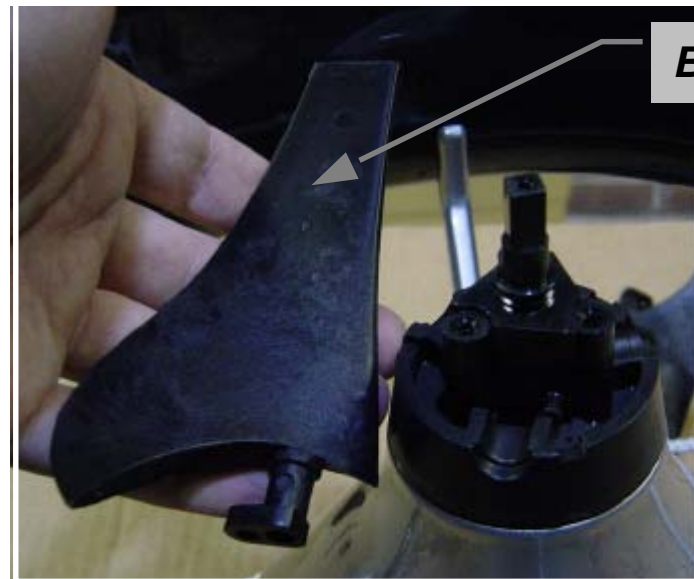

Blade

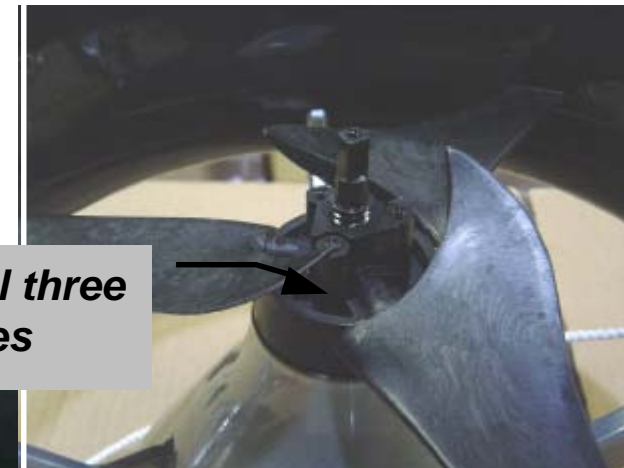

Fit all three blades

Match hole on prop with pin on yoke

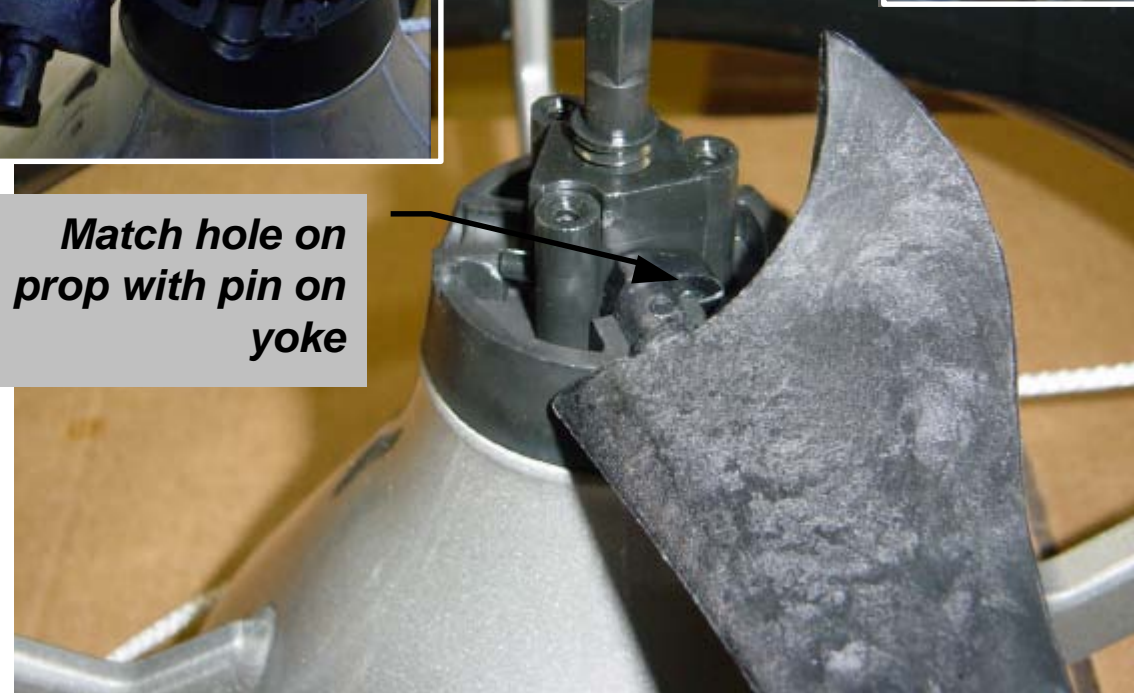

Stage 11

Fit Hub, Outer. Make sure it screws down fully and there is no gap at the base.

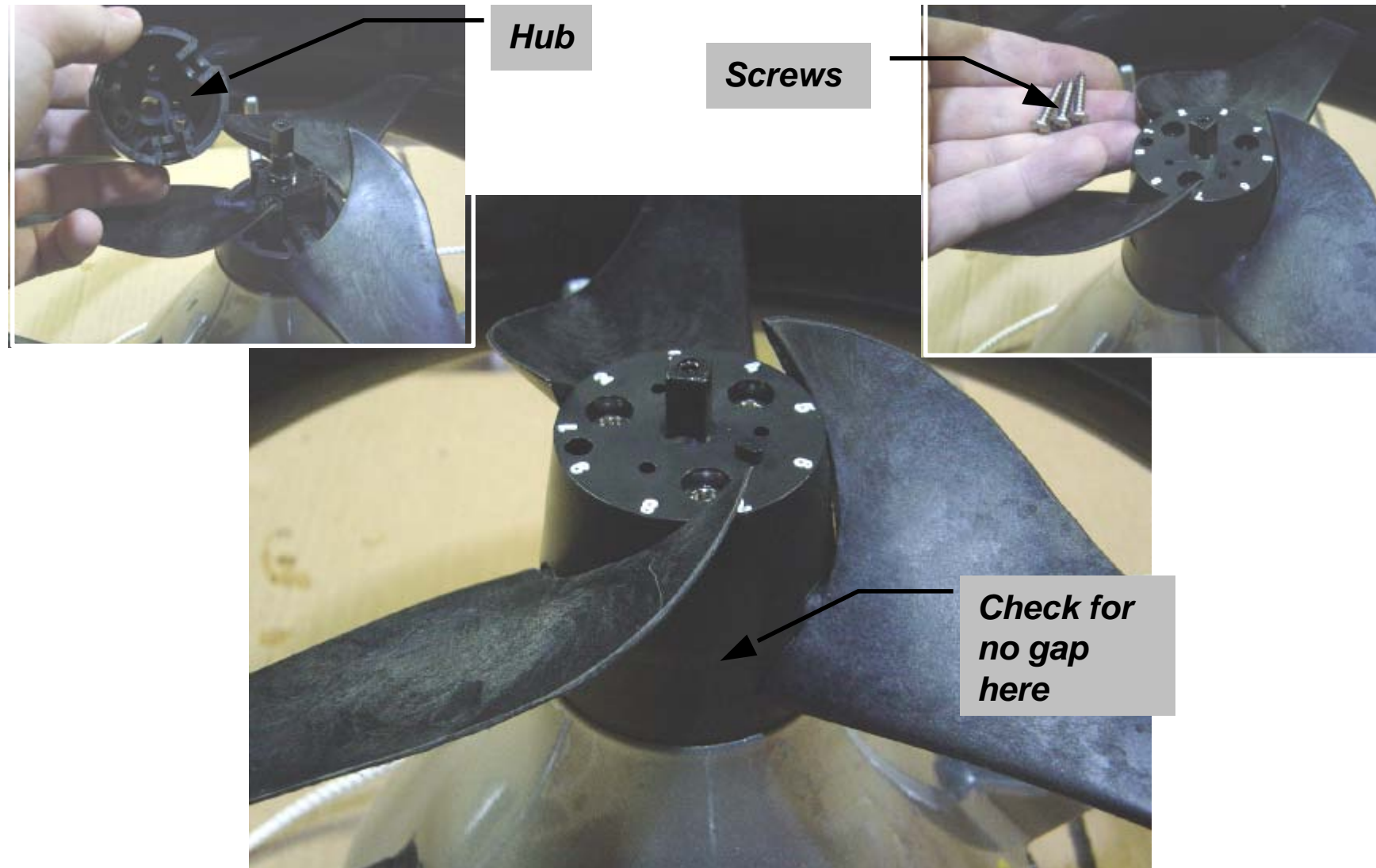

Stage 12

Fit Knob, Variable Pitch . First turn the square end of the shaft until the clearance between the hub and the propeller is about 1mm. Then fit the knob in position number "9"

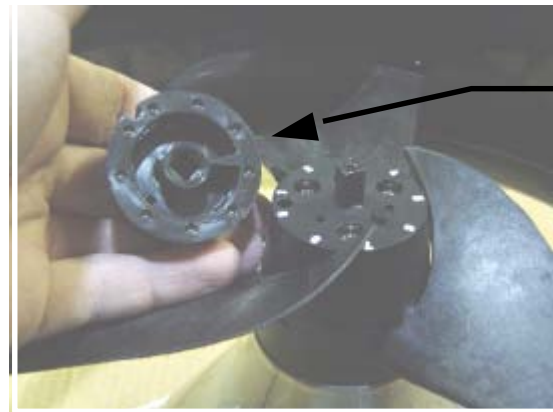

Knob

Screws



Number "9"

Check Clearance Here

